

PANDUIT PART NO.	MATERIAL	PACKAGE QTY.	LENGTH "L" ±.02	STAMP
MT172W38-C	304 SS.	100	1.72 [43]	P 304
MT350W38-C316	316 SS.	100	3.50 [89]	P 316

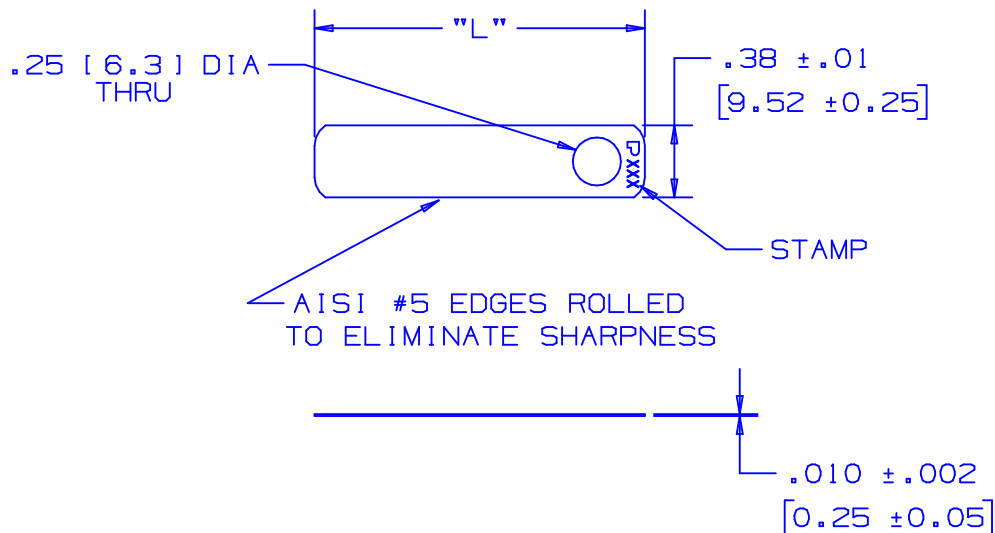

NOTES:

- DIMENSIONS IN [] ARE mm.
- CUSTOM PERMANENT MARKING AVAILABLE. CONSULT FACTORY.
- TOLERANCES:
 .XXX = $\pm .010$ [$.25$]
 .XX = $\pm .02$ [$.5$]
 .X = $\pm .03$ [$.8$] ANGLES = $\pm 2^\circ$

S41063_04

							PANDUIT CORP. TINLEY PARK, ILLINOIS		
							METAL TAGS - 1 HOLE		
04	5/05	JAMB		ADDED PART NO. MT350W38-C316 TO TABLE.	12679			UNLESS OTHERWISE SPECIFIED, DIMENSIONAL TOLERANCES ARE: (.X) ± --- (.XXX) ± --- (.XX) ± --- ANGLES ± ---	UNLESS OTHERWISE SPECIFIED, ALL DIMENSIONS ARE GIVEN IN INCHES, THIRD ANGLE PROJECTION.
03	10/03	BRH	DPN	REMOVED PART NO. MT350W38-C316 FROM TABLE.	11168	CCH	JJB		
02	5/02	JAMB	DPN	MAT'L FOR PART NO. MT172W38-C WAS 302 S.S. STAMP WAS "P 302"	10040	CCH	JJB	DRAWN BY SAM DATE 11/11/91 CHK'D JAC	SCALE FULL DRAWING NO. S41063 DWG SIZE A
01	1/01	KMD	JAC	REMOVED MT172W-38-C316 & MT350W38-C FROM TABLE. FILE SPEC WAS NPC_S41063_00	09063	CCH	JAC		
00	11/91	SM	JAC	RELEASED	00679	GJP	LA		
REV	DATE	BY	CHK	DESCRIPTION	ECN #	PM	CUST		